



TOYOTA LANDCRUISER 300 SERIES

2021 - CURRENT

All Models

TOWING MIRRORS INSTALLATION GUIDE

VERSION 2.7

Towing Mirrors

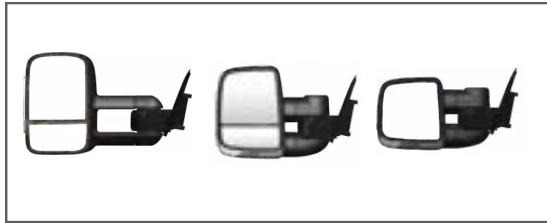

Power Boards & Swing Boards



Rock Tamers



Tyre Spider

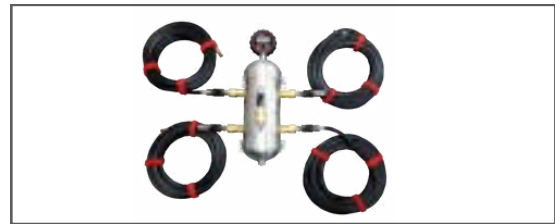

Easy Slides



Power Slides



Expanda Slides



Fridge Cage



Pantry

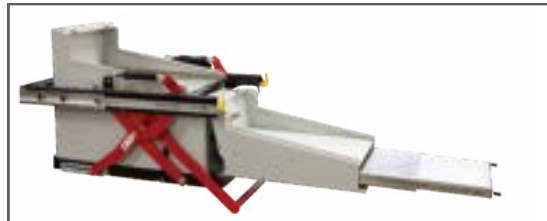

Cutlery Set



Clip on Trays

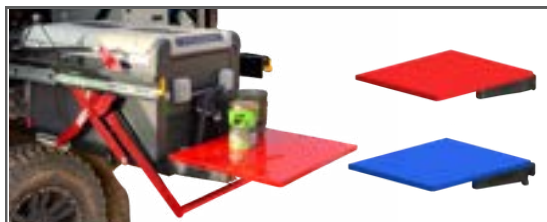

Cable Saver

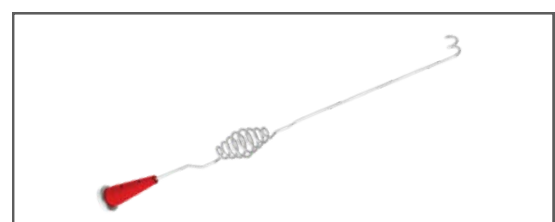

Thank you for choosing Clearview Accessories®

When it comes to road safety, having full visibility of your vehicle and your caravan, trailer or horse float is paramount. Clearview Towing Mirrors extend your field of vision when towing, changing lanes or reversing, to help see you to your destination safely. From Cape York's Telegraph Track to the Gibb River Road, Clearview Towing Mirrors are purpose-built tough for Australian conditions!

Clearview Accessories began in 2006, as a family-run business owned by entrepreneur, Mike Cowan and his son-in-law, Jay Praag. In the years that followed, Mike and Jay turned their small family business with three full-time employees, into one of Australia's most respected 4WD and Touring Brands.



With a strong passion for the automotive industry, quality design and discipline in professional workmanship, our trust is built within our values of creating high-quality ADR-compliant designs.

From humble beginnings, Clearview Accessories has grown and today manufactures a range of unique, quality products for your next off-road adventure!

Contact us:

Clearview Accessories,
3 Frog Court, Craigieburn VIC 3064
Phone: (03) 8351 9933
Email: info@clearviewaccessories.com.au
Website: clearviewaccessories.com.au

Find us on social media

-  facebook.com/clearviewaccessories
-  instagram.com/clearviewaccessories
-  youtube.com/clearviewaccessories

Due to Clearview's Continuous Improvement Program, information may change without notice. Clearview takes no responsibility for the result of incorrect use of these installation instructions.

Our Range	2
Introduction	3
Getting Started	5
Before You Start	6
Mirror Dimensions	7
Fitting Instructions	9-24
Maintaining Your Mirrors	25
FAQs	26
Troubleshooting	27-28
Warranty	29

Clearview Towing Mirrors are direct replacement mirrors that mount securely in the same position as your original mirrors.

What's in the box



- 1 x Left-Hand Side Mirror & Base
- 1 x Right-Hand side Mirror & Base
- 1 x LC-300-KIT-L Base Top Mount Kit
- 1 x LC-300-KIT-R Base Top Mount Kit
- 1 x Installation Guide



*For variants with 360° Camera (Camera Bracket Kit):

- 1 x Left-Hand side Bottom Access Panel with Camera Bracket
- 1 x Right-Hand side Bottom Access Panel with Camera Bracket

PRE 2025 BAP and Camera Brackets shown for illustration purpose only

If anything is missing, or damaged, please do not install your new mirrors and contact us on 03 8351 9933 or via: info@clearviewaccessories.com.au

Tools Required:

- 1/4" Ratchet wrench with a 10mm socket, or 10mm spanner/wrench
- T4 T-Handle hex key/4mm allen key
- Non-marring plastic trim removal tool/s
- Mini flat screwdriver
- Phillips screwdriver
- Micro phillips precision screwdriver
- Cutting pliers/side cutters
- White chalk pencil

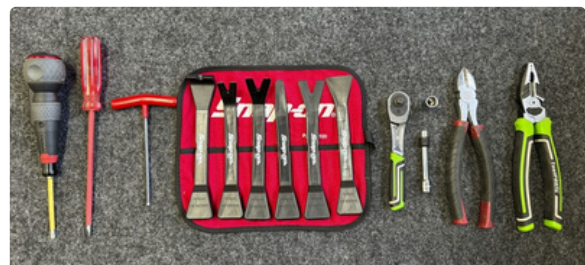

Whilst our mirrors can be installed by one person, the process is quicker and easier when an additional person is available to hold the mirror into position.



CAUTION



WARNING

- Read through the fitting instructions before installation of Clearview Accessories.
- Always install the accessory following the fitting instructions. Failure to do so may cause damage to the vehicle or the accessory and will void your warranty.
- Ensure all packaging materials are recycled and/or disposed of in accordance with local regulations.
- It is always recommended that this accessory is fitted by a qualified technician.
- Safely store and protect any removed vehicle components.
- Ensure all bare metal surfaces are protected using Automotive Bare Metal Primer and touch-up paint.
- Remove all metal swarf and dust from all vehicle surfaces if the surface is used for accessory installation.
- Your vehicle may be fitted with the Active Park Assist feature. You should only use this feature with your Towing Mirrors in the fully retracted, driving position.



WARNING DO NOT UNFOLD MANUALLY

If your mirror is equipped with Power Fold. In some cases, the mirror head may be loose before installation as the mirror head needs to be electrically folded and unfolded for a minimum of cycles on its first use to synchronize.

Please refrain from folding the mirror MANUALLY as it can reduce the life span of the product.

- **NB:** This mirror is designed to be manually folded upon impact as a safety feature.



COURTESY/PUDDLE LIGHT

Please understand that every car and every model is different and that some vehicles have different wiring options than other vehicles. We do not know the exact wiring configuration of your vehicle.

Should you wish to have the courtesy/puddle light feature installed, you will require the assistance of an Auto Electrician.

NB: Where there is an electrical modification of the vehicle, a suitably licenced person should undertake the work.

- IF HARD WIRING: **ORANGE WIRE: NEGATIVE (-) | GREY WIRE: POSITIVE (+)**

Compact Towing Mirrors

Non-Extended Standard Driving Position



Extended Towing Position

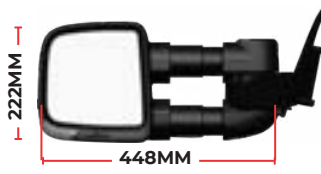

Fully Extended Towing Position

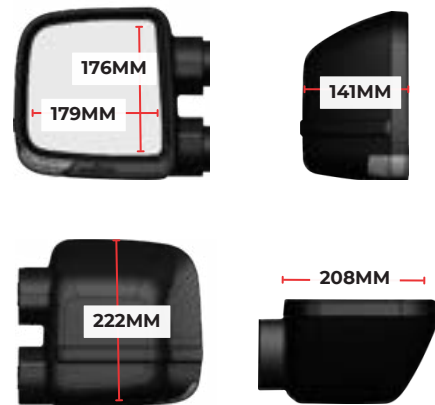
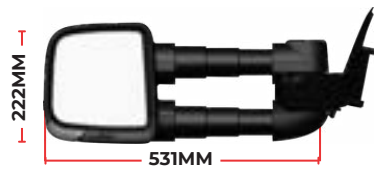

Next Gen Towing Mirrors

Non-Extended Standard Driving Position

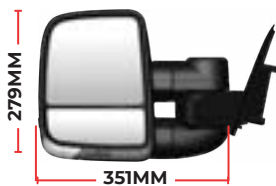

Extended Towing Position

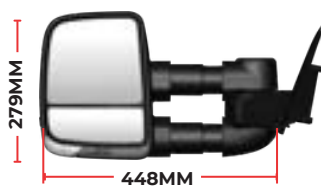

Fully Extended Towing Position

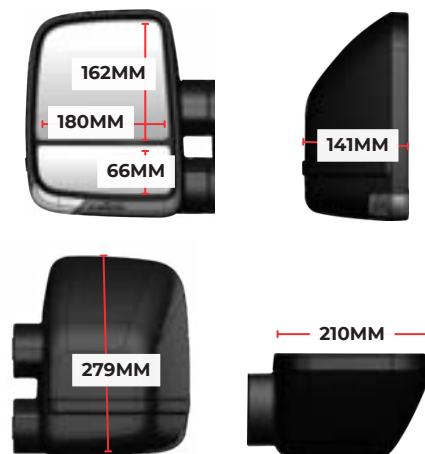
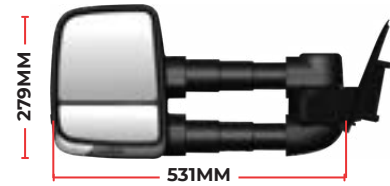

WARNING!

It's important that you disconnect the battery by removing the -ve terminal (disconnect the earth) prior to removing and disconnecting the side mounted mirrors.

If you remove a mirror to install Clearviews and test it without the circuit being complete, the vehicle will present errors, requiring the need to return the car to the Dealer at your expense to clear the code.



Cover the battery connectors with a fabric cloth to prevent accidental contact with the negative (-) battery terminal.

Step 1

Prepare vehicle

- 1.1 Place transmission into PARK position with handbrake ON.
- 1.2 Turn the ignition ON, then lower both front door windows.
- 1.3 Turn ignition OFF.



Cover the battery connectors with a fabric cloth to prevent accidental contact with the negative (-) battery terminal.

WARNING! It's important that you disconnect the battery by removing the -ve terminal (disconnect the earth) prior to removing and disconnecting the side mounted mirrors.

If you remove a mirror to install Clearviews and test it without the circuit being complete, the vehicle will present errors, requiring the need to return the car to the Dealer at your expense to clear the code.

Step 2

Remove door latch panel trim

2.1 Using a non-marring plastic trim removal tool, gently remove the door latch panel.

- Remove the screw beneath it using a Phillips head screwdriver.

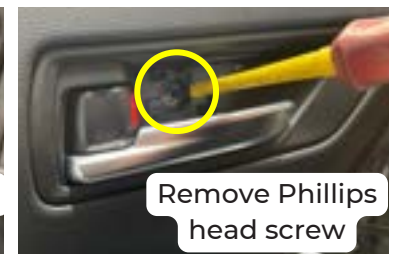

2.2 Gently lift and pry the window control panel upwards to allow access to the armrest trim.

NB: You do not need to remove the window control panel entirely. Pry upwards and let it rest.

- Now gently remove the armrest trim with a non-marring plastic trim removal tool.

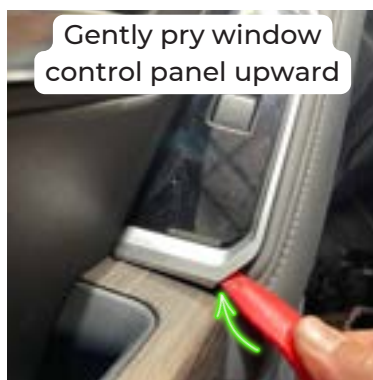

2.3 Locate and remove the x2 screws in the door panel as demonstrated.



Step 3

Remove door trim screw and courtesy light



3.1 Using a Phillips head screwdriver, locate and remove the screw located on the outer edge of the door.

3.2 Using a small flat plastic trim removal tool, carefully pry out and remove the courtesy light (or blank panel) from the door panel, then disconnect the wiring connector as shown.

- **NB:** Blank panel / Courtesy light will differ between vehicle variants, however, will still need to be disconnected as they are clipped in from factory.

Step 4

Remove door trim and window sill trim

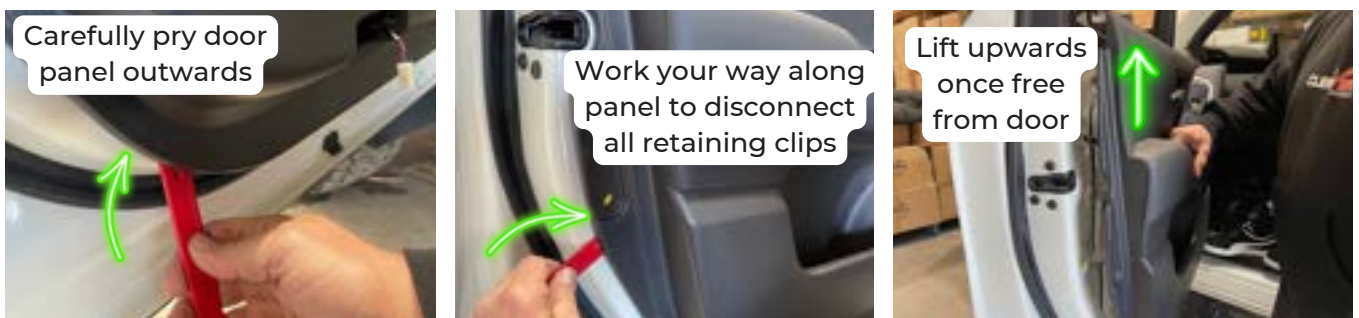

4.1 Insert a flat plastic trim removal tool at the bottom edge of the door trim, then pry outwards to disconnect from the retaining clips.

- Gently remove the door trim slightly, ensuring that you feed the door latch through the trim space, leaving it to hang in its position.

4.2 Locate and disconnect any wiring connected to the trim (door skin illumination) and wiring connector from the window control panel behind the door trim.

- Once all is disconnected, carefully remove the door trim and gently set it aside.

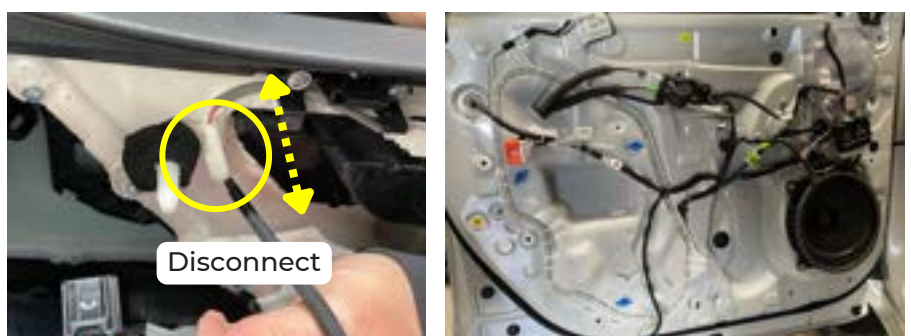



4.3 Carefully remove the entire window sill trimming by using a plastic trim removal tool.

- Unclip the window sill trimming from both the left and right bottom connector pieces.

Step 5

Disconnect Mirror Wiring and Connectors

5.1 Carefully disconnect the mirror's electrical wiring connector as demonstrated.

- Locate the screw mounted to the internal door access panel, then remove both plastic mount and screw with a Phillips head screwdriver.



5.2 Using the flat plastic trim removal tool, remove the plastic mirror housing cover by pushing in the tags on both the left and right sides to dislodge them from their fixed position.

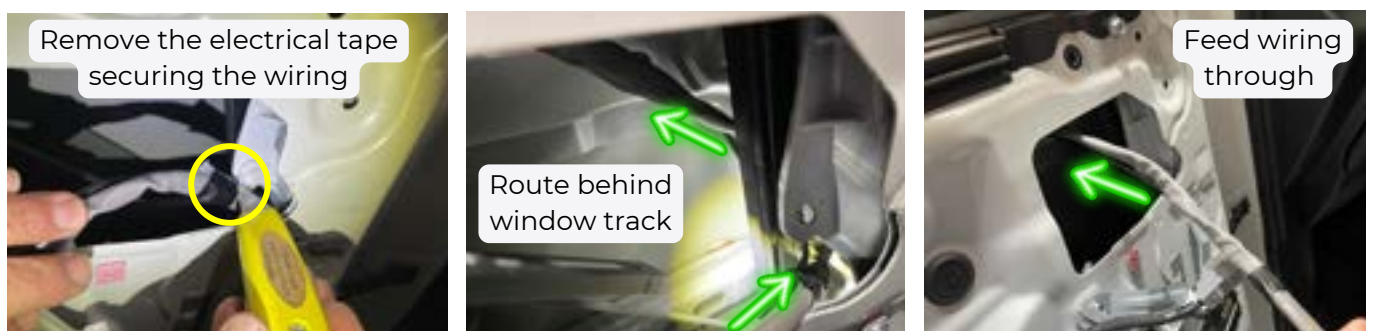

5.3 Begin by cutting back the tape securing the wiring to free up the wiring, then disconnecting the wiring connector. Ensure not to cut the wiring in the process.

- Feed the wiring through the hole to ease the removal of the OEM Mirror.

Step 6

Remove the outer door trim

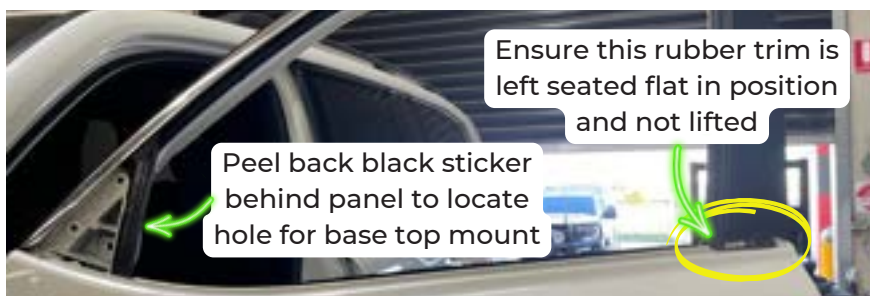
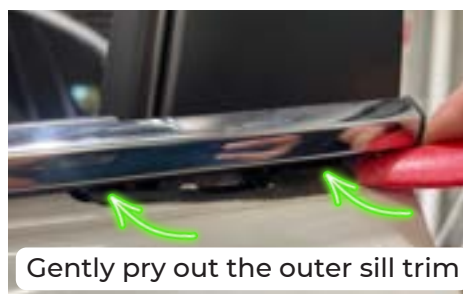

6.1 Use a plastic removal tool to gently remove the window sill trim first, then followed by the outer quarter panel as shown to free up the door skin.

Step 7

Remove the OEM mirror

7.1 Remove the x3 10mm Hex flange nuts that support the OEM mirror head through the inside of the door.

NB: Support the mirror during this operation.

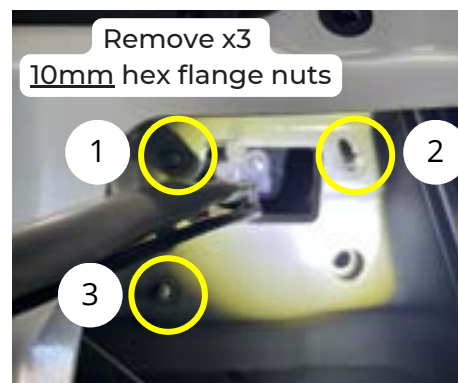

7.2 Remove the mirror from the doors, by tilting the mirror upward to clear the hook at the top corner of the mirror base.



HANDY TIP: Keep your original OEM mirrors as back up should something happen to one of your Clearview Mirrors, necessitating the need to return it to us for repairs.

Step 8 Attach the Towing Mirror to the Vehicle



8.1 Locate the Clearview supplied mirror gasket and the window sill trim.

- Apply the mirror gasket to the vehicle's quarter panel and secure it in place by re-aligning the window sill trim to door, then connect the base top mount over the mirror gasket.
- Feed the supplied M4 hex socket countersunk long screw (x1), just screw enough to locate the base top mount.

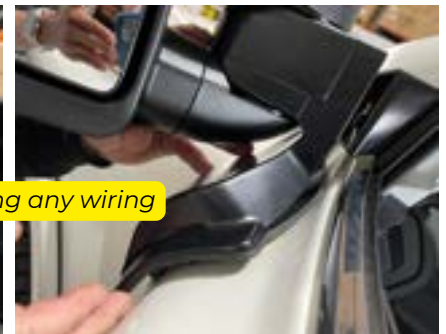
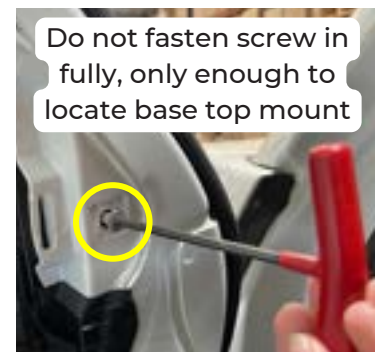

8.2 Present and locate the Towing mirror head base to the Door Panel mounting position.

- Tilt the mirror head upward, feed the wires through the mirror mounting hole and position the hook at the top corner of the mirror base into and under the door mounting panel.
- Now tilt the mirror head down and push forward until the mirror base is completely inserted into the opening in the door mounting panel, ensure the rubber gasket is aligned correctly

HANDY TIP: Keep your original OEM mirrors as back up should something happen to one of your Clearview Mirrors, necessitating the need to return it to us for repairs.

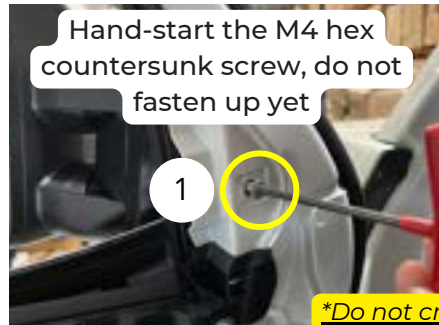

8.3 Ensure that the Clearview Towing Mirror Base's 4 mounting points are aligned to the factory points as shown. Do not fasten up tight until final tightening.

- Locate and hand-start the supplied M4 Hex Socket Countersunk Screw (x1), do not fasten up yet. Then hand-start the 10mm Hex Flange nuts (x3) to ensure mirror base is seated correctly and to avoid cross-threading.
- Once all is in the correct placement, tighten all 4 points above to secure the Towing Mirror head to the vehicle door. Tighten to a torque spec of approx. 11Nm-12Nm.

Step 9

Routing of Wiring



9.1 Route wiring behind window track to avoid being crushed or trapped and plug back in the mirror's electrical wiring connector to the module mounted in the door as shown.

NB: GX variants will have a different wiring connector and module, however, all steps will be the same. GXL and above variants all share similar wiring connector and module.

- Both examples are shown for reference.



GX variants only



GXL and above variants

IMPORTANT

- If the mirrors do not have the 360° camera feature, **SKIP to STEP 14.**
- If the mirrors contains the 360° camera feature, please follow the next steps.

Step 10

Remove OEM 360° cameras from the OEM mirrors



HANDY TIP: Place the OEM mirrors on a sturdy bench, we recommend placing down some cardboard or non-marking material on the bench to avoid scuffing the mirrors.

10.1 Locate the lens of your 360° Camera at the bottom of the OEM Mirror.

- With a white pencil, gently create a line from the middle of the camera toward the mirror glass to help with correct camera orientation.



10.2 Using a non-marring plastic trim removal tool, gently remove the mirror's exterior plastic cover.

- Start from the lower corner of the mirror head cover as shown, then work your way along the trim/clips etc.
- Separate the exterior mirror cover and set aside.



10.3 Gently remove the x3 screws as highlighted.

- Then carefully pry back to separate the mirror head shell only enough to gain access to factory camera bracket located at the bottom of the mirror head.

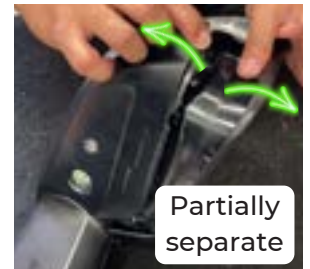
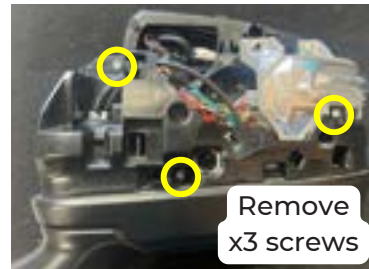

10.4 Remove the x2 screws to free up the factory camera bracket from the mirror head.

- Then carefully remove the x2 micro screws as highlighted.

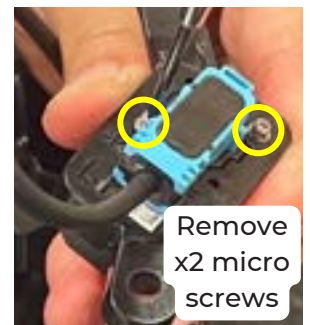
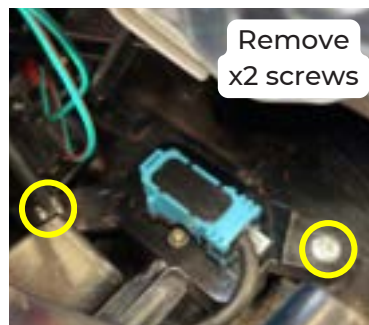

10.5 Disconnect the wiring connector located at the bottom of the 360° Camera, this will free up the 360° Camera from the factory bracket.

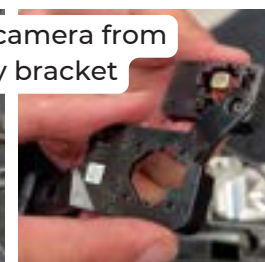
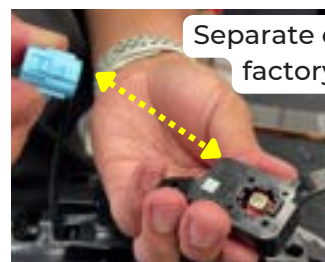
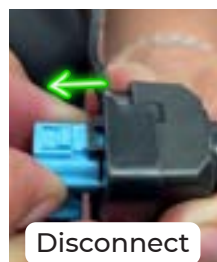

PRE 2025 BAP and Camera Brackets shown for illustration purpose only

TIP: DO NOT mix up the 360° cameras when removing them from the OEM mirror.

- **LEFT Camera** installed in the LEFT-HAND SIDE (LHS) Clearview Towing Mirror; AND
- **RIGHT Camera** installed in the RIGHT-HAND SIDE (RHS) Clearview Towing Mirror.

Step 11

Fitment of 360° Camera & Bottom Access Panel -

11.1 Opening in mirror housing should be clear for fitment of the camera bottom access panel and to provide access to the camera wiring plug.



11.2 Remove parts from the camera bracket kit.

- Within the shipping box with the mirror head, you will find a camera bracket kit for your make of vehicle.

Camera bracket kits contain:

- 1 x LEFT-HAND and 1 x RIGHT-HAND 360° camera bottom access panels
- 1 x LEFT-HAND and 1 x RIGHT-HAND 360° camera brackets
- 4 x camera bracket attaching screws

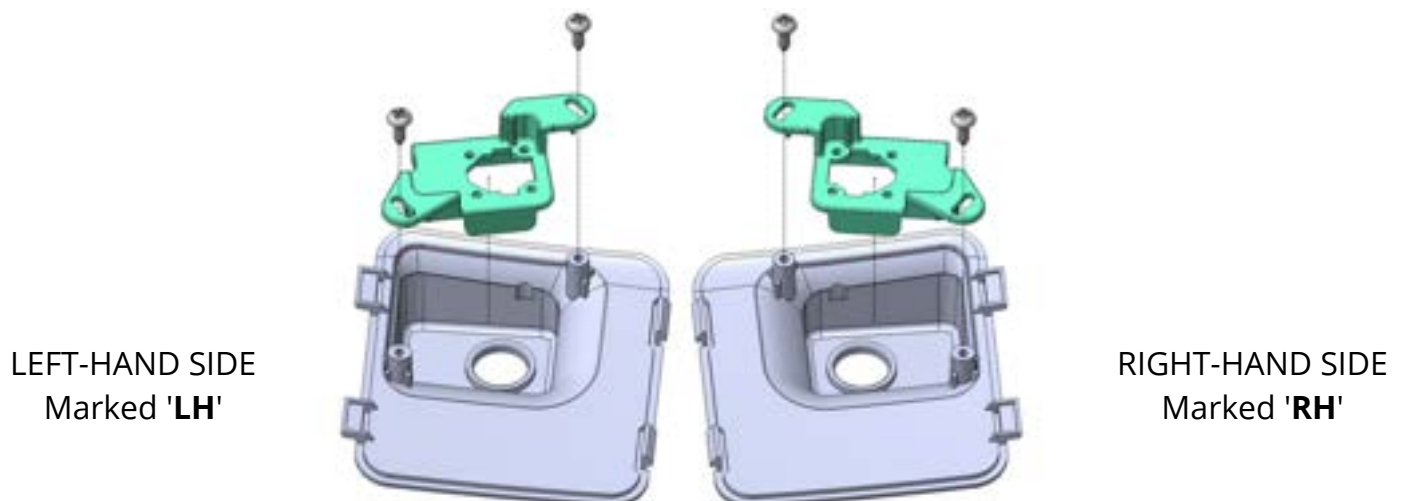

PRE 2025 BAP and Camera Brackets shown for illustration purpose only

Tip: DO NOT mix up the 360° cameras when removing them from the factory mirror.

- The **LEFT Camera** to be installed in the LEFT-HAND SIDE (LHS) Clearview Towing Mirror; AND
- The **RIGHT Camera** to be installed in the RIGHT-HAND SIDE (RHS) Clearview Towing Mirror.

11.3 Assemble OEM 360° cameras to new bottom access panels. Align the 360° camera in position using the camera brackets and screws provided in the kit.

- Do not securely tighten the screws yet.

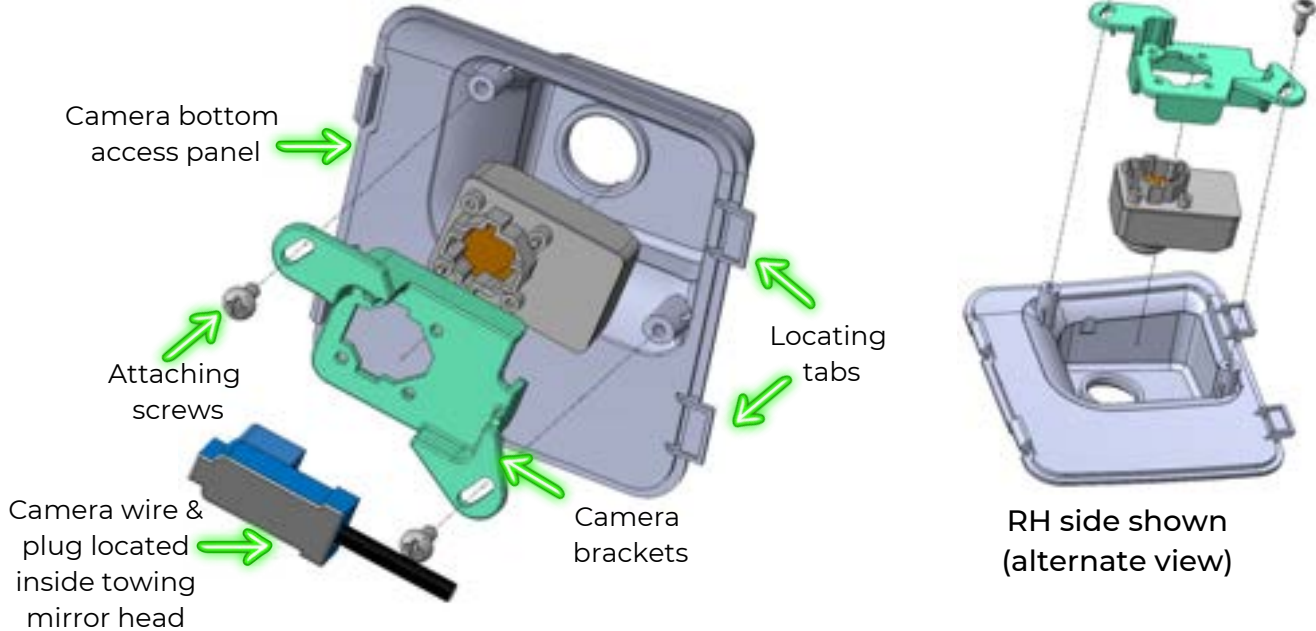

11.4 Align OEM 360° cameras such that the camera bracket wings are positioned over the mounting lugs and locating pins, as shown.

11.5 Secure the OEM 360° cameras to the new camera bracket supplied by using the locating pins and the micro screws previously removed from the original vehicle camera brackets as highlighted.

- Ensure the White mark on the 360° cameras in STEP 10.1 is toward the mirror glass.

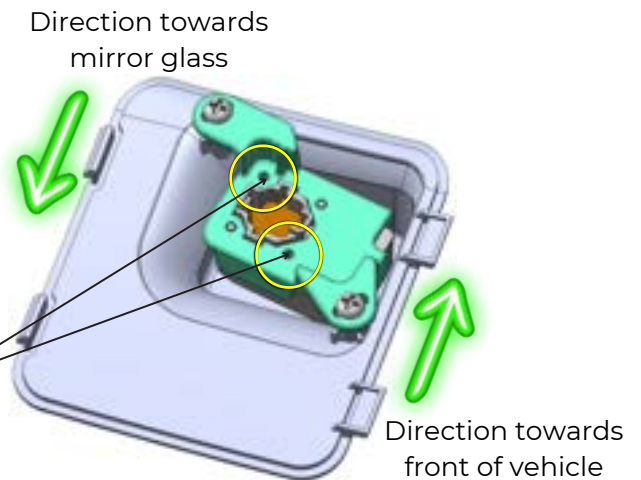

11.6 Position the camera brackets, as shown, with the attaching screws located approximately in the mid-point of the slots.

- The attaching screws can now be fastened, however, may need further adjusting in the subsequent steps.

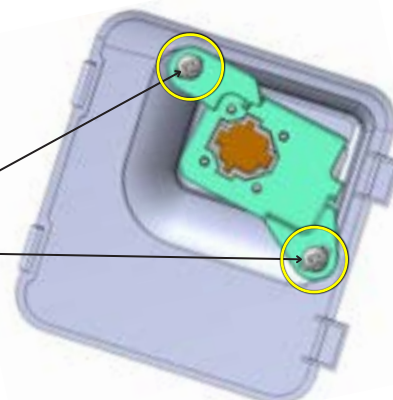

NB: RH Side Images for illustration purposes only

PRE 2025 BAP and Camera Brackets shown for illustration purpose only

Step 12

Fit bottom access panels with 360° camera to towing mirror head

RH side
only shown

NB: RH Side Images for illustration purposes only



With the OEM 360° camera secured to the bottom access panel – begin with the Right-Hand Side mirror head.

12.1 Locate the camera wiring plug immediately inside the mirror head.

12.2 Connect the female wiring plug to the mating male plug on the camera wiring lead, the wiring plug will only fit if correctly orientated.

12.3 Ensure the 2 mating plugs are completely connected.

12.4 As you position the bottom access panel to the mirror head, allow the wiring to fit into the mirror head opening.

12.5 Ensure that the wiring is not trapped or interfering with the fitment of the bottom access panel.

12.6 Position the lower access panel's 2 locating tabs into the slots in the mirror head opening. These slots are on the outside of the mirror head.

12.7 Now pivot the inner side of the bottom access panel up until the locking clips are in contact with the mirror head opening.

12.8 Apply localised pressure to this edge of the bottom access panel until the locking clips snap into position.

12.9 The bottom access panel and camera assembly are now in position.

12.10 REPEAT Steps 12.1 to 12.9 for the LEFT-HAND Side Mirror.

Step 13

Check and adjust camera alignment on vehicle

13.1 Preparation for testing

- Position the vehicle on a flat clear surface, and ensure no obstructions when testing.
- Ensure a minimum space of 1 metre is clear on each side of the vehicle.
- Place 2 parallel lines on the floor surface, approx. 500-600mm away from vehicle wheels. (The one in our example is 600mm.)
- These parallel lines should run approximately the full length of the vehicle.
- The parallel lines must be thick enough to be visible on the vehicle's 360° camera screen – approx. 50mm thick. The use of masking tape is suggested.

NB: Refer to the vehicle owner's manual for instructions as to how to access the vehicle 360° camera screen.

13.2 View camera alignment

- Turn on the vehicle's 360° camera screen - refer to the vehicle owner's manual.
- With the bottom access panel & 360° camera assembly securely in position on the towing mirrors, close all vehicle doors fully.
- Whilst seated in the vehicle, view the 360° camera screen to check the alignment of the parallel lines on the floor surface.
- You want to see these lines being parallel to the longitudinal centreline of the vehicle, as shown below.
- If the lines are not parallel, you may want to adjust the angle of the 360° camera on the lower access panel until these lines are parallel.

NB: The alignment does not need to be perfect; this is only a guide, adjust to your preference/desired position.

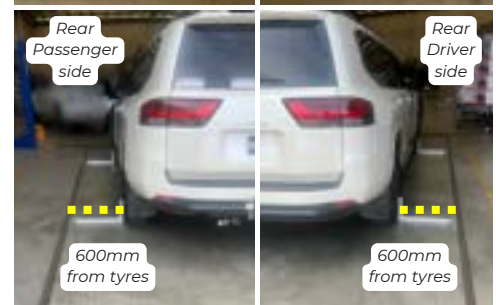
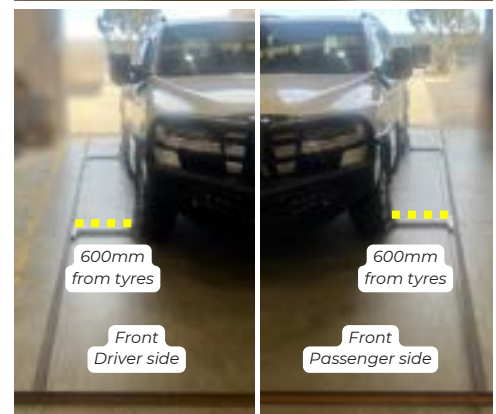
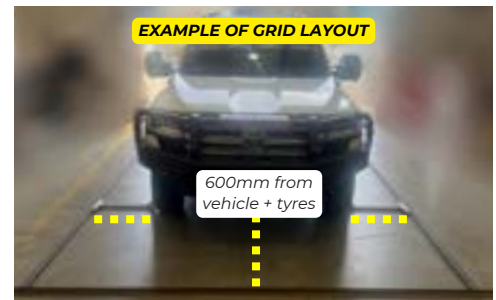

**For demonstration purposes only*

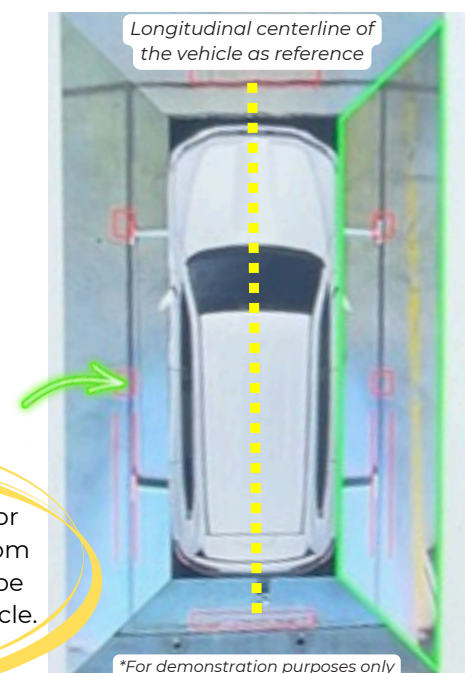

**For demonstration purposes only*

50mm line marked on floor surface approx. 600mm from vehicle wheels. Ensure to be parallel to centerline of vehicle.

Step 14

360° Camera Calibration (via the factory infotainment display)

Toyota LC 300 Series 2021 - 2024 models Only

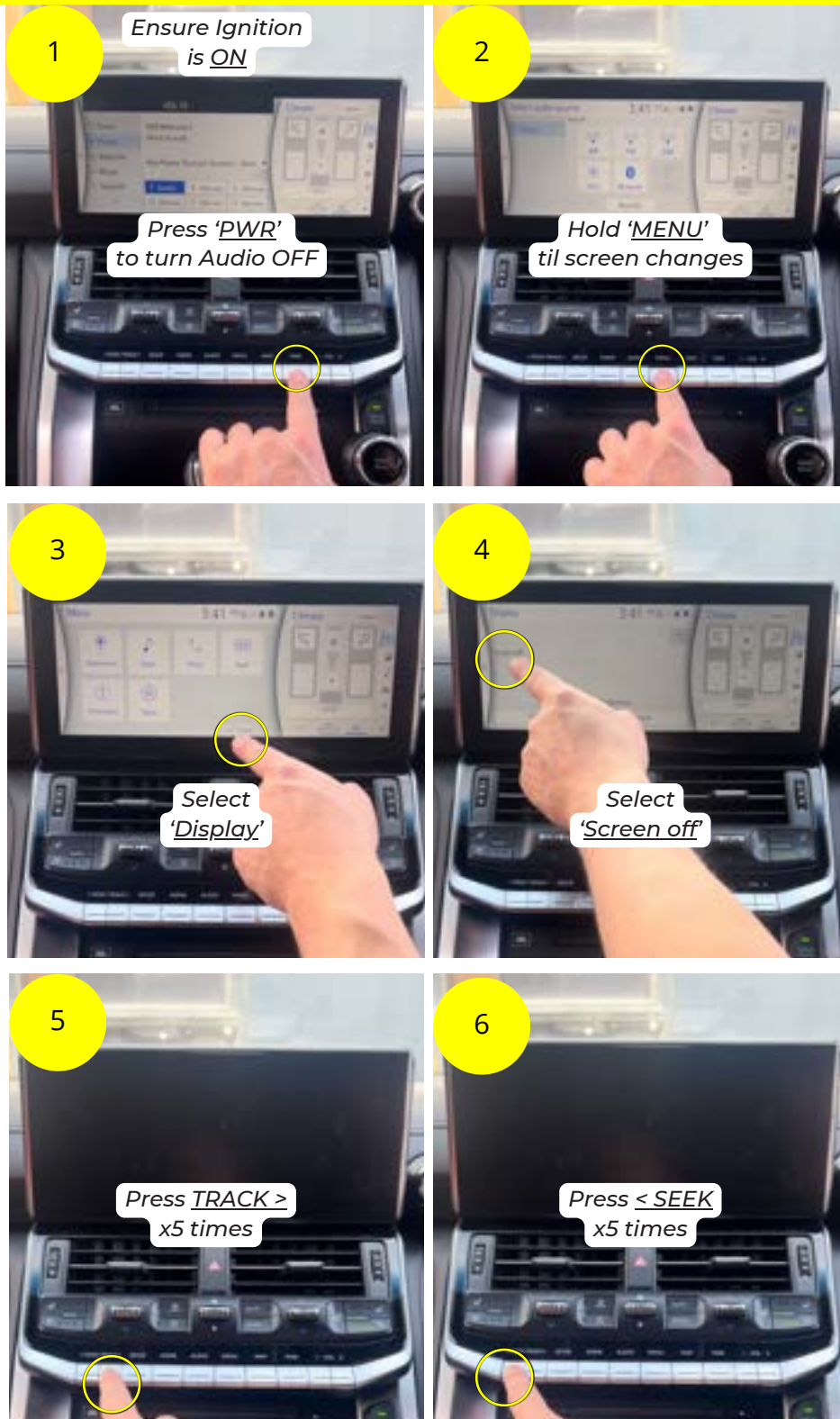

IMPORTANT: Clearview is not responsible for improper use of these functions. Do so at your own preference. Refer to Toyota should you require other assistance regarding the camera system or any other vehicle specific features etc.

Toyota LC 300 Series 2021 - 2024 models Only

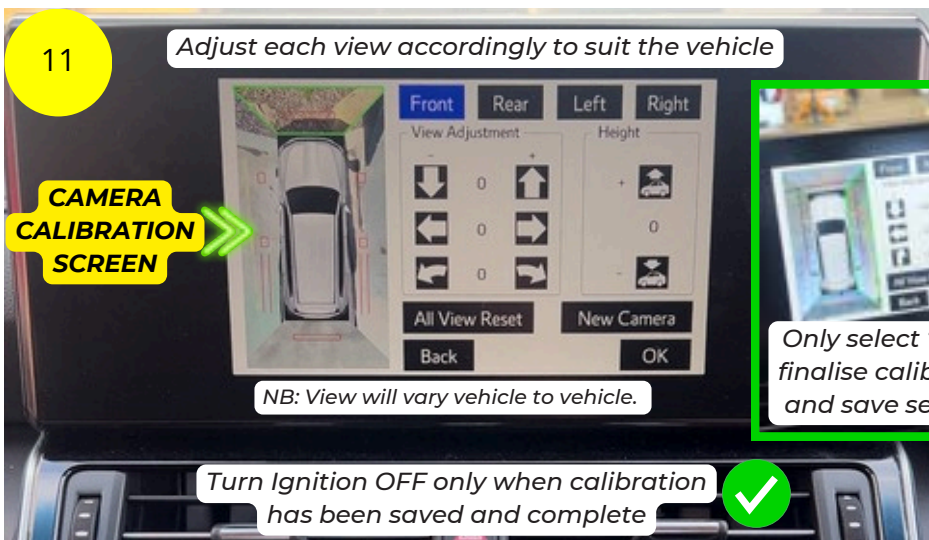
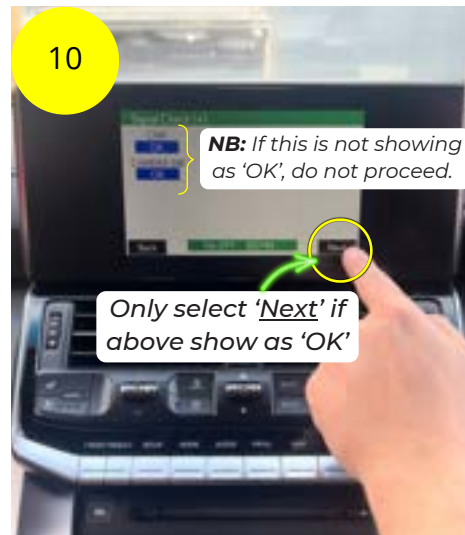
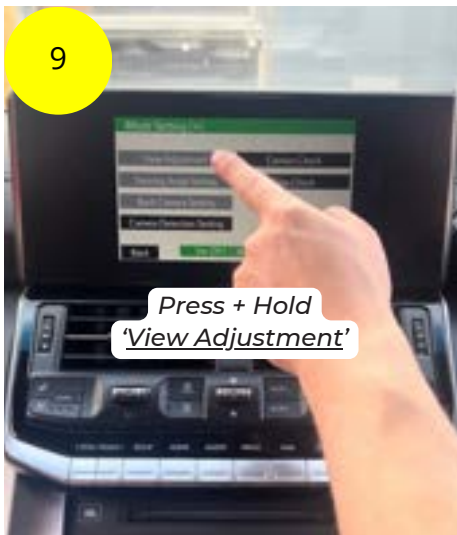
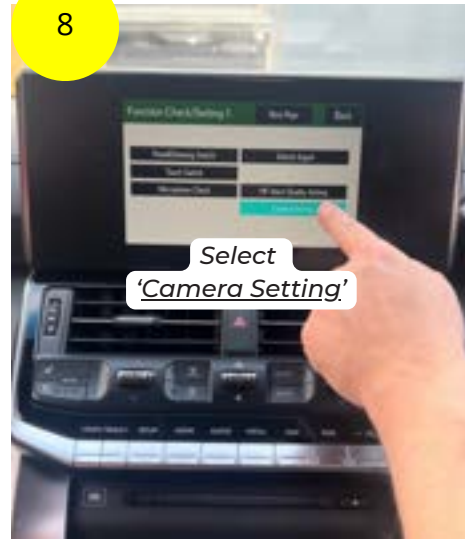

IMPORTANT: Clearview is not responsible for improper use of these functions. Do so at your own preference. Refer to Toyota should you require other assistance regarding the camera system or any other vehicle specific features etc.

Step 14

Adjust 360° camera alignment on vehicles

Toyota LC 300 Series 2025 - Current models

View 360° camera alignment

1. Turn on vehicle 360° camera screen – refer to vehicle owner’s manual.
2. With Clearview towing mirrors firmly attached and electrically connected to vehicle and lower access panel & camera assembly securely in position, close all vehicle doors fully.
3. Ensure that the mirror heads are fully retracted and in the drive position. Operate the mirror fold feature to ensure in drive position.
4. Whilst seated in the vehicle, view the 360° camera screen to check the alignment of the parallel lines on the floor surface – the black (Masking lines)
5. If the lines are not parallel, you may want to adjust the angle of the camera on the lower access panel until these line are parallel. Refer below for instructions on how to adjust the cameras.
6. Ensure the parallel lines are properly aligned to provide customers with an accurate view of the parking guidelines
7. Repeat above steps for the LH camera.

Adjust/rotate camera bracket & camera assembly, either clockwise or anti-clockwise, to achieve required adjustment.

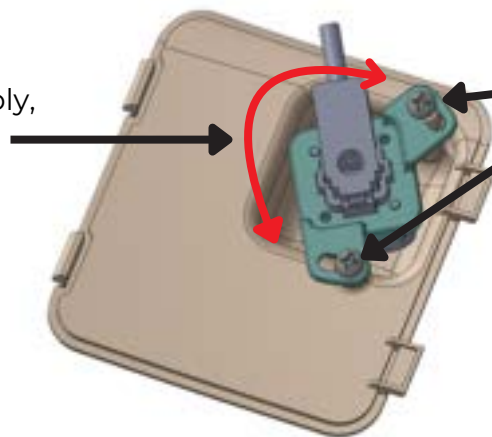

2 attaching screws to be unscrewed loose for camera alignment adjustment.



Step 15

Test the Mirrors

- **15.1** The battery **-ve Terminal** which was disconnect at **Step 1** can now be reconnected.
- Turn ignition on and operate the mirror function of Towing Mirror based on features available in vehicle.
- Test your mirror functionality to ensure they run correctly - UP, DOWN, LEFT, RIGHT etc.
- Indicate LEFT, Indicate RIGHT, Test HAZARD Lights etc.

NB: If your mirror/s are not functioning correctly, refer to Troubleshooting on [Page 27 & 28](#), OR follow the instructions again in case a step has been missed.



'Auto Mirror Tilt' feature when transmission is in 'REVERSE' gear (for *GXL and above variants only*)
Please refer to the Toyota Owners Manual for more information.

Step 16

Tidy up wiring

16.1 Ensure to tidy up the mirror wires neatly by using a cable tie (or factory tag) to secure them together.

NB: Ensure no wires are trapped in this process and are kept away from the window track.

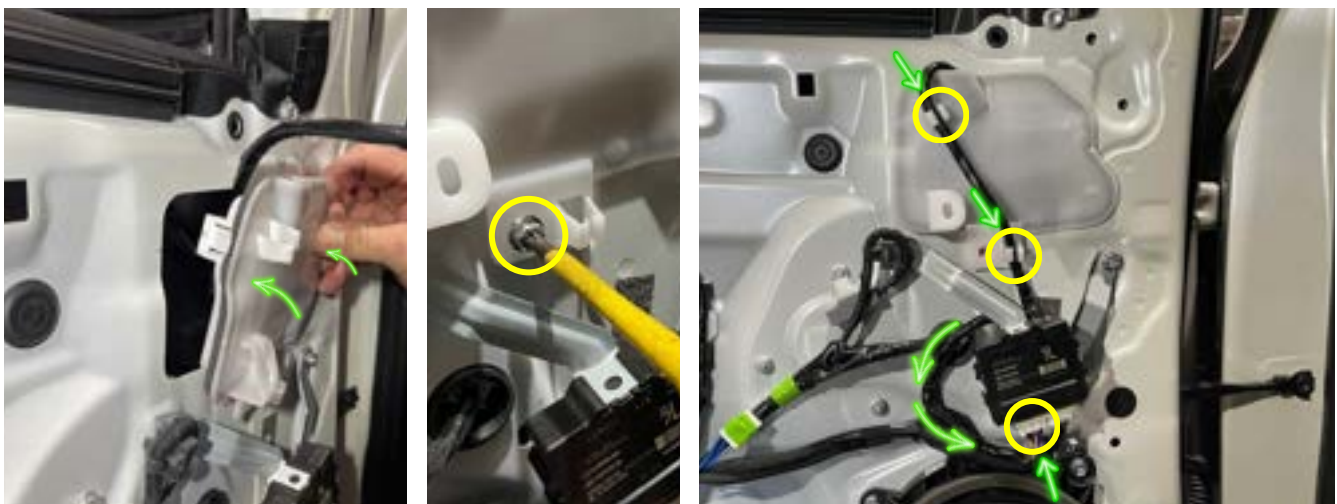

16.2 Re-align the Mirror Mounting Hole Cover and apply previous screw back into position.

- Then, re-align the wires into it's allocated holder as highlighted above.

NB: Ensure to tuck the wiring loom back under the module bracket when routing back into position.

Step 17

Reassemble the Door Trim



17.1 Re-align and secure the door trims into their original position, ensuring no wires or cables are trapped in the process. Follow and **REPEAT** STEPS 3 and 4 in REVERSE ORDER to help with getting the trims back into place.

17.2 Once the large door trim has been mounted in place, follow and **REPEAT** STEP 2 in REVERSE ORDER to assist you with putting all the screws, panel trim, courtesy light (or blank panel) and wiring back into their fixed position.



NB: Ensure you feed the courtesy light wiring through the hole located in the bottom rear corner in the large door trim before re-connecting the wiring to the connector on the courtesy light/blank panel.



IMPORTANT:

Ensure that there are no trapped wires in any of the previous steps so that all door and mirror functions work as they should.

Congratulations! You have now fully installed your new Clearview Towing Mirrors and are ready for your next adventure!

Maintaining Powder Coated Surfaces

Whilst powder coating is a lot more durable, and longer lasting than paint, it can still be affected by dust, dirt, salt water and constant exposure to the weather. For this reason, no protective powder coating is completely maintenance-free.

With the right maintenance, you can increase the life of the finish of your powder-coated surfaces:

- Harsh chemicals and solvents can damage the powder coating. Once damaged, the surface is a lot more vulnerable to fading and failure.
- We recommend regularly inspecting your powder coat and wiping any dust off with a soft cloth. Clean, good-quality microfibre cloths are recommended.
- We recommend regular washing with highly diluted mild soap and water. Use a soft towel to gently clean. Rinse and dry with another soft drying towel/chamois.
- If your powder coat is losing its shine, you can apply a thin layer of high-grade non-abrasive car wax after it's been cleaned. Wipe all the wax off once it's dried and the powder coat should look like new again! Use a car wax brand that contains a UV blocker or UV inhibitors. Do not use compound-type waxes as they contain abrasives that can harm the powder coating.
- It's important in coastal areas to regularly clean any powder-coated surfaces as salt will stick to the coating, dulling its appearance. This can leave your powder-coated surface looking chalky.
- We don't recommend paint touch-ups to cover imperfections as paint won't adhere to powder-coated surfaces. A local professional can quote to repair the powder coating.

How do I maintain my Powerfold mirrors?

Under regular Powerfold operation, there shouldn't be any maintenance required, however, if it is regularly used off-road, then the mirrors may need to be maintained every 6-12 months.

- This maintenance involves pulling the mirror into the fully extended position and applying dry lubricant on the arms, not the arm covers.

Maintaining your Chrome Mirrors

The chrome finish used on our mirror heads is a chrome-plated plastic, which provides the appearance and feel of real chrome, in a more lightweight and cost-effective material.

Weather conditions, how often they are washed and how close to the ocean you live, all play a role in the longevity of the chrome finish.

- Automatic car washes that use bristle brushes or acidic preparations can damage your chrome
- Salt and de-icers will surface pit chrome and extra care will be required with more frequent washes to remove residue.
- We recommend washing them weekly with mild soap and water, steering clear of ammonia-based or acid solutions.
- Clean, good-quality micro-fibre cloths are recommended to wipe down the chrome surface and prevent water stains from forming
- An occasional polish with a non-abrasive chrome polish will help bring your chrome back to its original shine!

NB: If chrome isn't properly maintained, it can develop pitting from corrosion or lose its attractive shine. We recommend **Autosol Metal Polish** and **Autosol Metal Life Saver**.

Can I install Clearview mirrors myself?

Yes! Depending on the complexity of the installation, Clearview mirrors are extremely easy to install and mount to the vehicle's original OEM mirror mounts. Depending on the vehicle's current mirror options, Clearview mirrors include plug-and-play wiring looms. Instructional videos are also available on our website (clearviewaccessories.com.au) in the 'HOW TO' section. Clearview recommends that any installation requiring hard wiring be done by a licensed auto electrician.

What is the fitting time?

Depending on the complexity of the installation, the fitting will vary from vehicle to vehicle. Any installation requiring any special fittings and/or hard wiring will require longer fitting times (eg. 360° Camera fitting/calibration, any electric hard-wiring kits, OAT sensors, and any other complex installations etc).

NB: Fitting times will also vary depending on the skillset or capabilities of the fitter.

Please contact Clearview Accessories if you have any questions about fitting or wiring.

Are the telescopic arms electric?

No. The telescopic arms are extended manually. Clearview Mirrors will only fold against the vehicle electronically provided we make that model in Power Fold.

Can I retrofit the original mirror base to the Next Gen or Compact mirrors?

No. The cost of converting the mirrors to suit the new models is not worth it. We recommend either selling your Original mirrors privately or through the 'Pre-Loved' section (Within the 'Shop' menu category) of our website and purchasing the new Next Gen or Compact mirrors brand new.

Can I add an indicator later if I didn't order the mirrors with an indicator?

Yes, you can. But it comes at a greater expense than if you were to order the mirrors with indicators. Installation of the mirror head will require a longer time and more parts to dismantle.

Are spare parts available?

Yes. We have a list of spare parts for all our mirrors on our website. Our dealers also have a list of all our spare parts. If you cannot find the parts that you require, please contact Clearview Accessories, or any of our dealers to assist you with your enquiry.

How do I maintain my mirrors?

We recommend that Clearview Mirrors are lubricated every 6-12 months, when the arms feel stiff during use, or after any big trip to ensure longevity of your Clearview Towing Mirrors!

This maintenance includes pulling the mirror into the fully extended position and applying the dry lubricant on the arms. We recommend using WD-40 Specialist Dry Lubricate.



Avoid any waxy lubricants as they can attract dirt and grit.

**SCAN THE QR CODE
AND VIEW OUR VIDEO
DEMONSTRATING**

How to lubricate the arms
on Clearview Towing Mirrors



I have just installed my new Powerfold mirrors and the mirror heads appear 'loose'/'floppy'.

After the mirrors are installed, they need to be cycled a few times. This will allow all the internal mechanisms to set and find the proper positions.

- If the mirror head is still loose/floppy after they're cycled, please contact Clearview Technical Support.

I have installed my Powerfold Mirrors and have noticed that the Passenger's side mirror is closer to the vehicle compared to the Driver's side; Is this normal?

This is entirely normal. In most vehicles, the mirror housings are angled differently between the driver's and passenger's sides.

- This is because when you sit in the car, the mirrors are positioned from/to the driver's position (which is off-centre), so generally, the passenger side mirrors are closer to the vehicle body to allow you to have the same field of vision in the mirror.

One of my Powerfold Mirrors folds/opens quicker than the other one; Is this normal?

Generally, the passenger mirror will fold/open quicker, as it is closer to the vehicle body and therefore travels a shorter distance compared to the driver's side mirror.

(Refer to the previous question in regards to why the mirrors are angled differently.)

My mirrors have been knocked out of the Driving Position; how do I fix it?

Press the powerfold switch once. This should initiate the powerfolding motors and the mirrors should start folding inwards. Wait until the mirrors are fully folded in and have stopped moving, then press the powerfold switch again. This should now bring your mirrors back out to normal driving position. Check and see if the mirrors are locked into position firmly. If the mirror is not returning to its normal position, please contact Clearview Technical Support.

- **NB:** *The Powerfold mirrors can fold manually, however, the manual fold mechanism is only designed as a safety feature. Throughout the lifespan of the product, manual-folding will occur, such as people walking into them or accidentally bumping them. The internal mechanisms are designed to withstand this accidental manual folding during normal usage. It is not recommended for the mirrors to be manually folded constantly, as it will prematurely wear out the internal folding mechanisms and reduce the lifespan of the product.*

My mirror was knocked out of the driving position. When I cycled them, there is a clicking sound and the mirror appears to have 'jumped'; Are my mirrors damaged?

When the Powerfold mirror is being cycled to find its original driving position, it will 'jump' back into position and make an audible click sound when mechanisms realign. Once the mirrors have found the original position and have been cycled, check for looseness and mirror movement. If they feel firm, then the mirrors have not been damaged. If they still feel loose, please contact Clearview Technical Support.

Why don't my mirrors fold all the way in/out when I press the switch?

The circuit breaker inside the mirror activates when the electrical current increases due to resistance. If the mirror stops before it reaches the folded in/out position, that means something is adding resistance while the mirrors are folding, hence activating the circuit breaker before it has reached the desired position. Please contact Clearview Technical Support.

Clearview Towing Mirrors® are full replacement towing mirrors designed and manufactured to the highest quality standards to replace your vehicle's standard side mirrors. We stand behind our Next Gen and Compact Towing Mirrors with a 3-year Manufacturer's Warranty and 7-year Parts Warranty. We stand behind our Original Towing Mirrors and Classic Towing Mirrors with a 12-Month Manufacturer's Warranty and a 3-year Parts Warranty

Please ensure that your receipt is kept in a safe place. A receipt will be required to make a warranty claim on any Clearview product. If we determine that a Clearview Towing Mirror is defective in materials or workmanship during the Warranty, we will either repair or replace the product. Repair or replacement is solely at the discretion of Clearview Accessories.

Please ensure that you fit the Clearview products in accordance with the product information provided and all relevant vehicle safety and compliance laws; and use the Clearview product for the purpose for which it was originally designed. This warranty does not apply to failure or damage caused by incorrect or faulty fitment, accidental or intentional damage, alteration, acts of nature, vandalism, collision, road hazards or adverse conditions, misuse, abuse or neglect of the Clearview product, including improper repair or maintenance or failing to repair and maintain the product, failure of other products, operation of the product outside of its environmental or technical specifications, or repair or modification carried out by anyone other than Clearview Accessories®. No charges will be accepted for external labour or materials without the prior advice or clearance from the Clearview claims team. Clearview Accessories® warranty does not cover any scratches or chips.

Clearview Towing Mirrors are designed to be vehicle-specific. When purchasing Clearview Towing Mirrors, carefully select your product according to ADR compliance laws and vehicle specifications. Clearview Towing Mirrors are not designed to be modified for convenient use on alternative vehicles. Alteration, modification, or manipulation of our products will void all warranty with Clearview Accessories.

All claims under this warranty should be lodged through our website warranty section <https://www.clearviewaccessories.com.au/about/warranty/> with the detail of the fault, proof of purchase, proof of identification and vehicle fitment details where relevant. If your claim is accepted for defects in material or workmanship Clearview will, at its discretion, offer to repair, replace parts, or return and refund.

Our goods come with guarantees that cannot be excluded under the Australian Consumer Law. You are entitled to a replacement or refund for a major failure and for compensation for any other reasonably foreseeable loss or damage. You are also entitled to have the goods repaired or replaced if the goods fail to be of acceptable quality and the failure does not amount to a major failure. In the event of a minor failure, the company reserves the right to choose to repair or replace the product.

Clearview Towing Mirrors® | ABN: 59 140 145 393 | 3 Frog Court, Craigieburn VIC 3064
Phone: (03) 8351 9933 | Email: info@clearviewaccessories.com.au







CLEARVIEW[®]
ACCESSORIES

Head Office

3 Frog Court, Craigieburn
VIC 3064, Australia
(03) 8351 9933

QLD Office

Unit 1/49 Doherty Street, Brendale
QLD 4500, Australia
(07) 3204 7693

info@clearviewaccessories.com.au

clearviewaccessories.com.au