

Package Contents and Assembly Instructions



ES-100 / ES-150 FRIDGE CAGE

Package Contents

Number	Part	Quantity
1A-1B	Bottom Side Panels	2
2A-2B	Height Adjustable Side Panels	2
3A-3B	Top Side Panels	2
4	Bottom Back Panel	1
5	Height Adjustable Back Panel	1
6	Roof Panel	1
7	Hex Head Cage Screws (2.5MM)	30
8	Philips Head Cage Mounting Screws	6

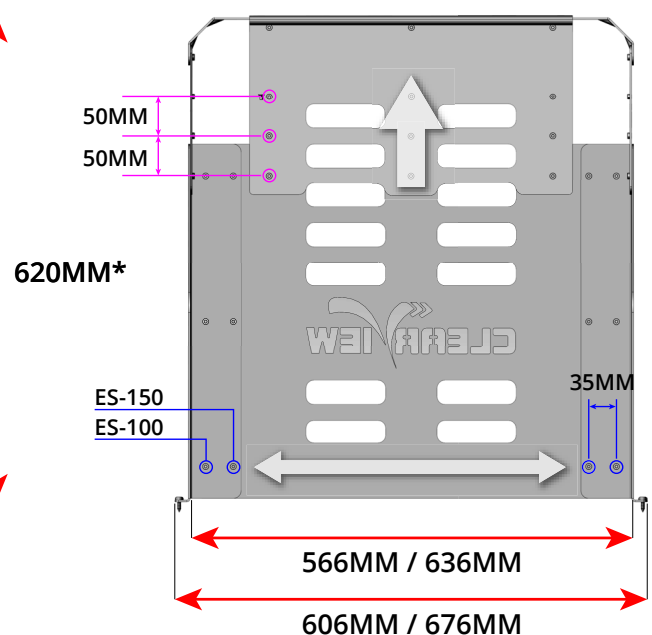
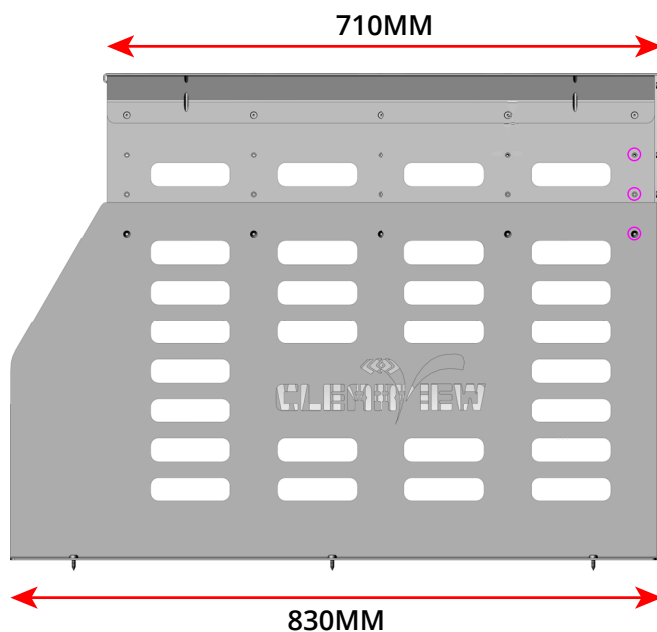
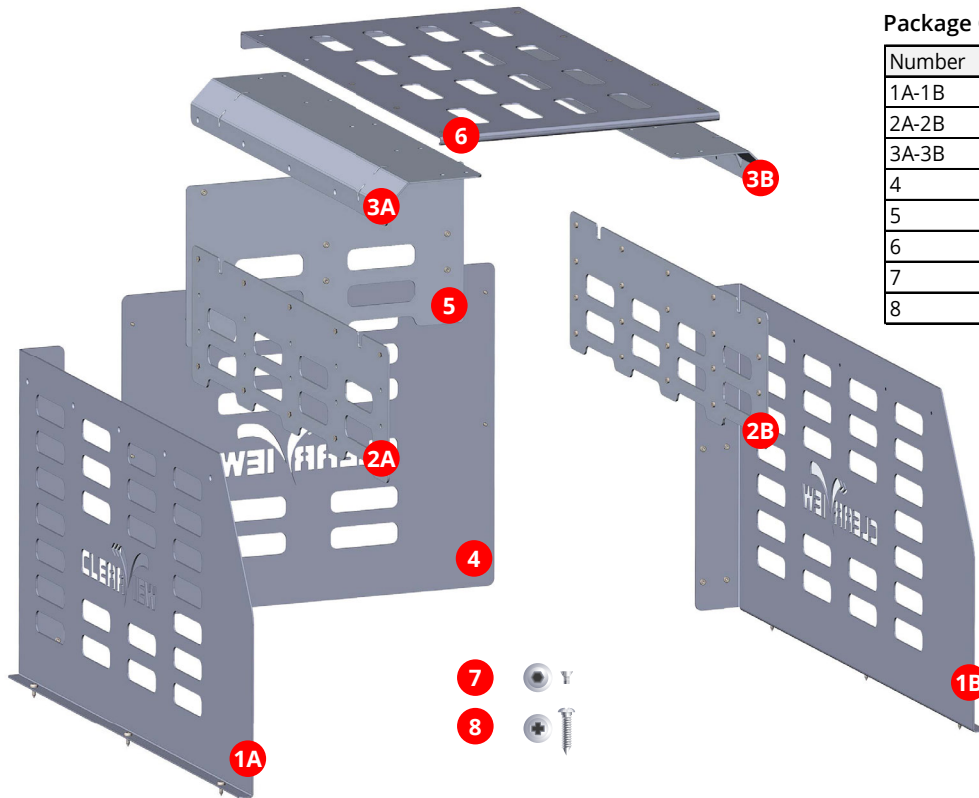

- Pre-Drilled cage width adjustment holes
- Pre-Drilled cage height adjustment holes

* Fridge Cage maximum height is 620MM. The height is adjustable in 50MM increments with the 3 pre-drilled height adjustment holes on the side and back adjustment panels. Fridge Cage maximum external width is 676MM (ES-150) including securing lip.

Assembly of the Fridge Cage Requires

- 2.5MM Allen Key
- Philips Head Screwdriver

1 Measure Height & Width of Your Fridge / Pantry

- Measure the height & width of your Fridge / Pantry. If fridge has insulation, ensure that the measurements are taken with that in consideration



2 Attach Top Side Panels to Roof Panel

- Using the 2.5MM Hex Head screws, attach the Top Side Panels to the Roof Panel (3A-3B to 6)
- Note: Be careful when screwing in panels with the Hex Head screws. Screw holes are pre-drilled in aluminum frame and forcing a screw into the thread will strip out the tapping

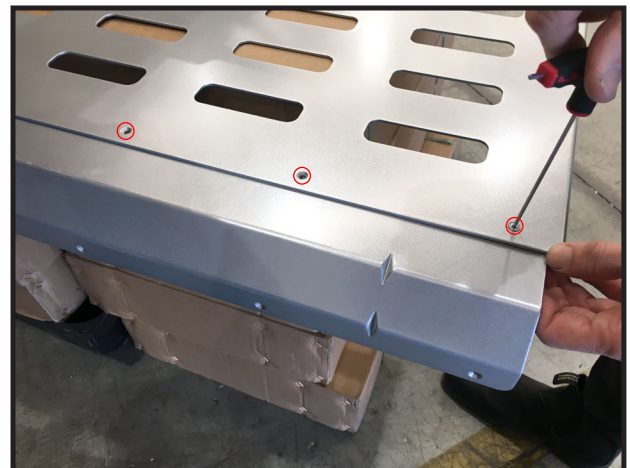

3 Attach Back Top Panel to Back Bottom Panel

- Taking into consideration the height of your fridge/pantry, use hex head screws to attach back top panel to back bottom panel (4 to 5)



4 Attach Adjustable Height Side Panels to Bottom Side Panels

- Keeping the same height preset as the back panel configuration, attach the adjustable side panels to the bottom side panels with the hex head screws (1A-1B to 2A-2B)



5 Attach Built Side Panels to Built Back Panel

- Taking into consideration the width of your fridge, using the 2.5MM Hex Head screws, attach Built Side Panels to the Built Back Panel
- Using pre-drilled width adjustment holes, attach panels to desired width ES-100 / ES-150



6 Attach Built Roof Panel to Built Side & Back Panels

- Using the 2.5MM Hex Head screws, attach Built Roof Panel to the Built Side & Back Panels. This will complete the build of the Fridge Cage

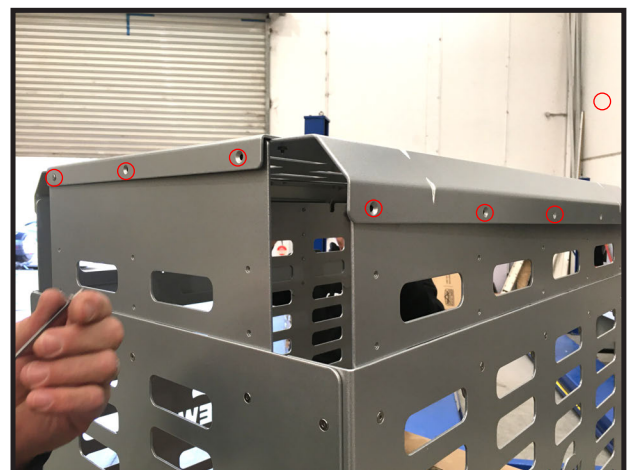

7

Screw in Built Fridge Cage in Mounting Position in Vehicle

- Now that the Fridge Cage is built, screw in the Fridge Cage in position in your vehicle with the 6 Philips Head screws
- Ensure that the base is screwed in securely and there is no moving vibration sounds



Enjoy Your New Fridge Cage!



If you have any questions or require assistance, please contact Clearview Accessories or any of our dealers. The Fridge Cage comes with a 12 month warranty. Please see Clearview Accessories website for Terms and Conditions.



clearviewaccessories.com.au