

# Original Mirror: Glass and Mount Assembly



## 1 Large Flat Mirror

Part Number: SP-FMG-L/R\*

Note: Top Flat Glass can be purchased as a separate item, but if glass has heating or blind spot, the kit must be purchased (See Item 6 Options)

## 2 Small Convex Mirror

Part Number: SP-CMG-L/R

## 3 Star Washers (2)

Part Number: SP-STARWASHER

## 4 Swivel Cup

Part Number: SP-SWIVELCUP

## 5 Convex Mirror Backing Plate

Part Number: SP-CMK-L/R

Note: Convex mirror backing plate comes as a kit which includes the convex mirror. Backing plate can not be purchased as a separate item

## 6 Flat Mirror Backing Plate

Part Number: SP-FMK-L/R\*

Note: Flat mirror backing plate comes as a kit which includes the flat mirror. Backing plate can not be purchased as a separate item

Optional Parts:

SP-FMK-H-L/R\*: Heated Glass

SP-FMK-P-L/R\*: Heated Glass + Blind Spot

## 7 Tension Fingers (3)

Part Number: SP-LST

## 8 Actuator

SP-A-E: Electric Actuator Motor

SP-A-M: Actuator Manual Mirror

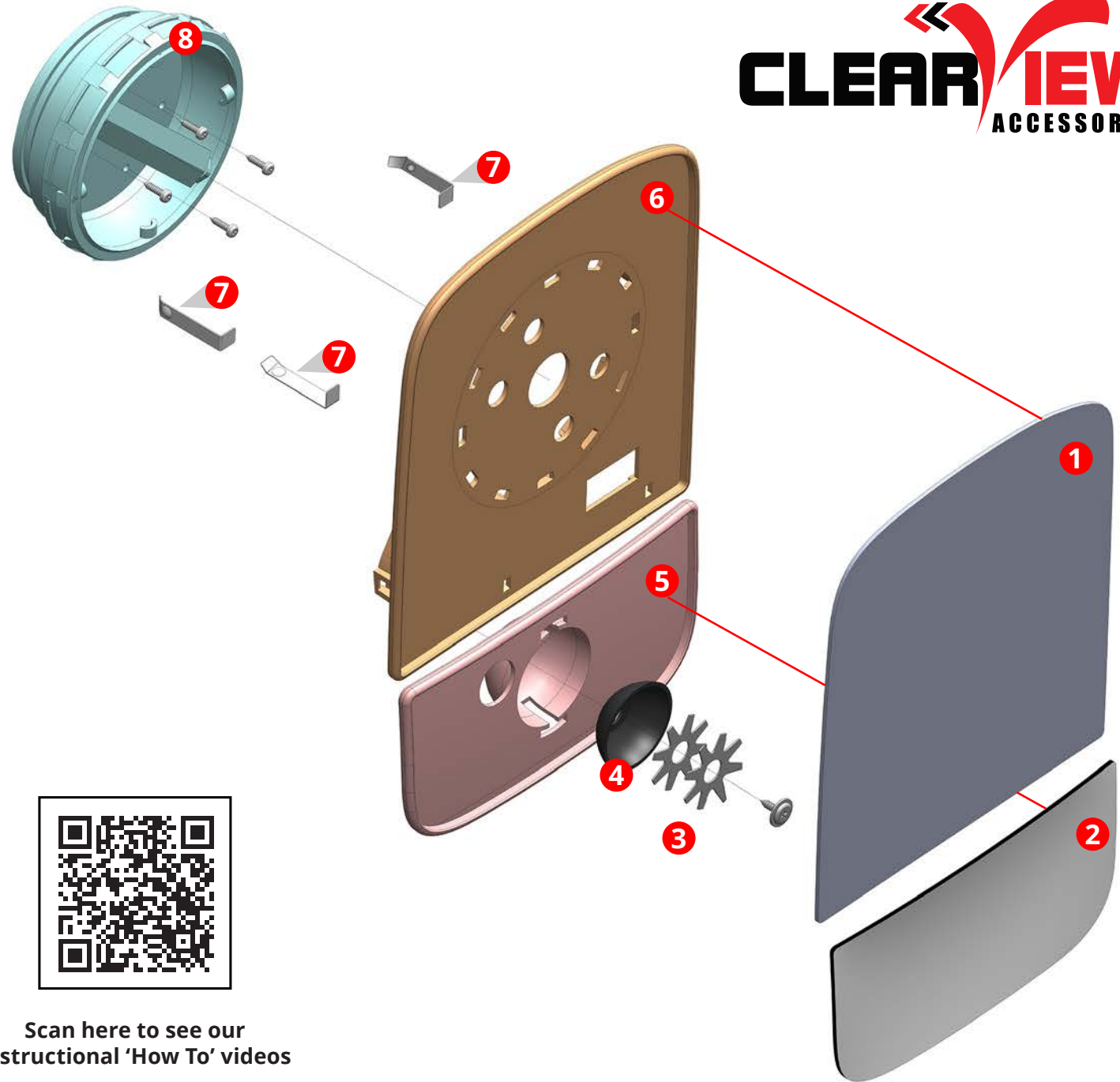

Scan here to see our  
instructional 'How To' videos

Please contact us direct if you have any questions about spare parts, mirror repair or assembly  
info@clearviewaccessories.com.au (03) 8351 9933

\* Upper mirror has convex option as well  
Note: The options are dependant on make and model of vehicle